

# ChristchurchNZ

James Brickland  
Trade Partnerships Executive



## CHRISTCHURCH & CANTERBURY

- Great Alpine Highway
- Alpine Pacific Touring Route
- Inland Scenic Route 72
- South Canterbury Heritage Trail
- North Canterbury Food & Wine Trail

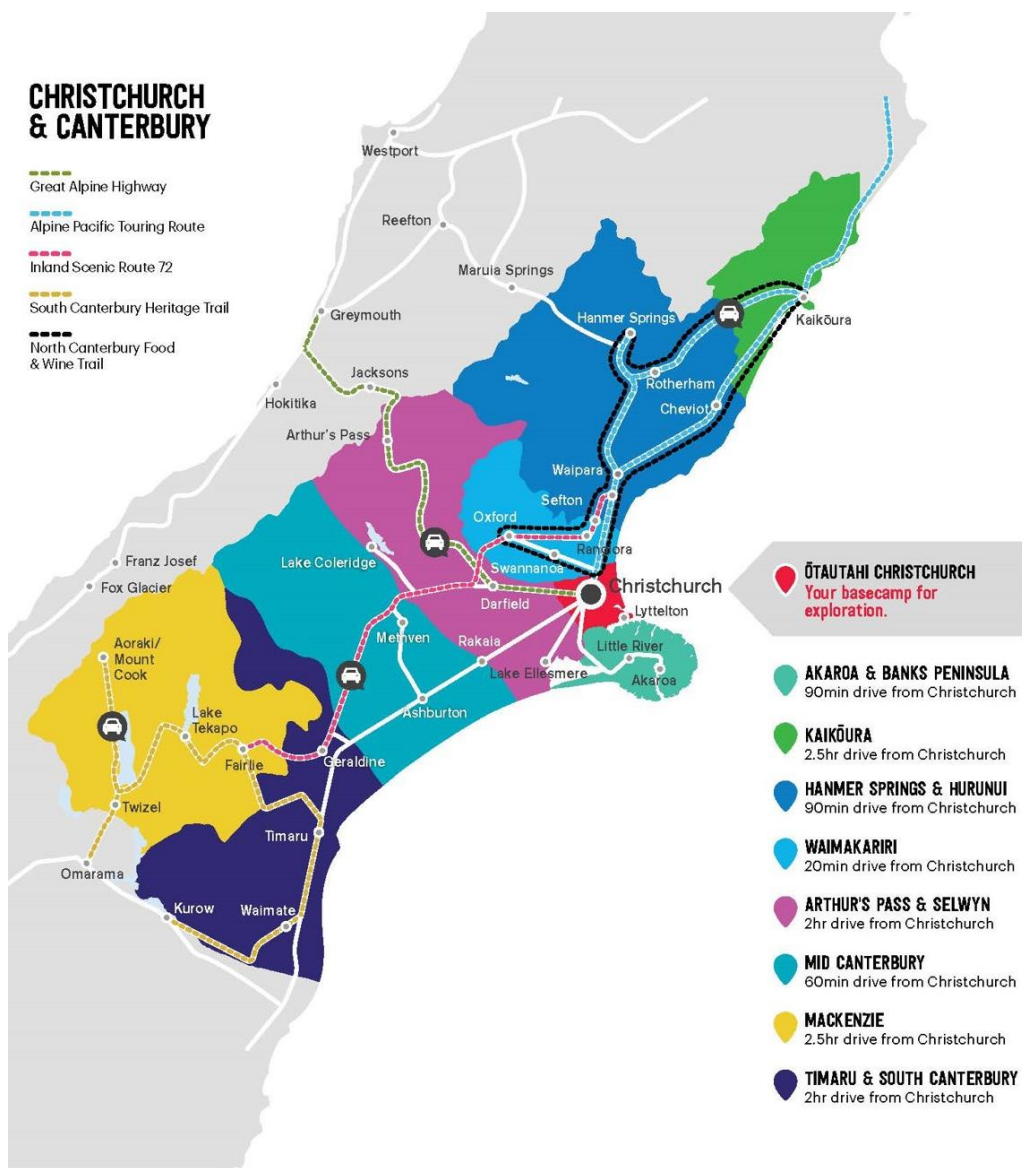

**ŌTAUTAHU CHRISTCHURCH**  
Your basecamp for exploration.

- **AKAROA & BANKS PENINSULA**  
90min drive from Christchurch
- **KAIKŌURA**  
2.5hr drive from Christchurch
- **HANMER SPRINGS & HURUNUI**  
90min drive from Christchurch
- **WAIMAKARIRI**  
20min drive from Christchurch
- **ARTHUR'S PASS & SELWYN**  
2hr drive from Christchurch
- **MID CANTERBURY**  
60min drive from Christchurch
- **MACKENZIE**  
2.5hr drive from Christchurch
- **TIMARU & SOUTH CANTERBURY**  
2hr drive from Christchurch

# Our Region

Ōtautahi Christchurch is a city reimagined, a place for everyone, from everywhere. New Zealand's second largest city, this urban hub at the heart of the scenic South Island is stacked with street art and distinctive visitor attractions, serene botanic gardens and green spaces in every direction. Feel warmly welcomed by our world-class hospitality and diverse accommodation offerings, and marvel at our state-of-the-art architecture alongside the country's best heritage gems.

Explore by bus, e-bike, gondola, tram or punting boat, and walk around the vibrant central city to discover riverside markets and global cuisine, laneway shopping and rooftop bars. Wander among The Arts Centre, one of the most significant collections of heritage buildings in New Zealand, and follow the charming Ōtākaro Avon River as it meanders through beautiful gardens before continuing through the central city and out to sea.

From the coastlines of Banks Peninsula, lush vineyards to sky-piercing mountains and pristine glacial lakes, Canterbury is a region of remarkable contrasts. It is a haven for those seeking peace and harmony, while also the thrill of new experiences and adventure.

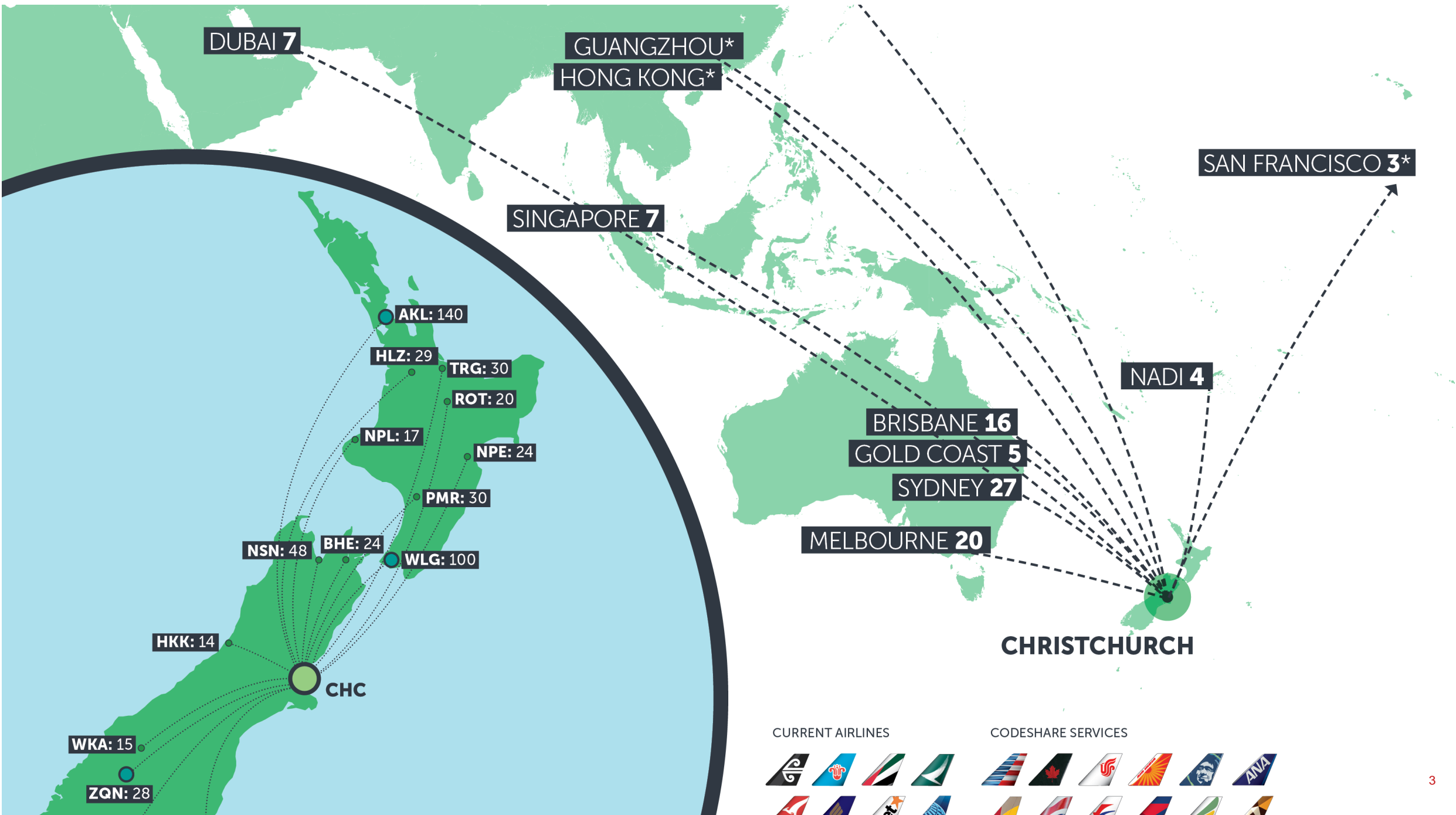



# Getting around

---

## GETTING TO CHRISTCHURCH IS EASY

After flying into New Zealand's second largest airport it is a short 15 minute drive to get into the central city. The city is flat and compact, making it easy for visitors to travel around the city.

### Airport transfers

The central city is located just 10 kilometres from Christchurch Airport. There is an airport bus service into the central city Bus Interchange. There are regular shuttle and taxi services into the city as well as an electric bus service, and electric car share schemes.

### Walk, scooter or bicycle

Explore our flat compact city by foot — what better way to experience a new destination. There are several electric scooter and bicycle share schemes — perfect to explore and cover more distance while enjoying the outdoors.

### Public transport

Christchurch has an excellent bus service, with the Interchange right in the heart of the city. Visitors can travel inexpensively by bus to most major attractions around the city.

### Day trips

There are numerous options for visitors to explore the wider city and region taking in some of the South Island's incredible highlights. Mountains to oceans, vineyards and thermal resorts all within an hour of the city.

### Train

The Coastal Pacific and TranzAlpine train journeys are truly spectacular, and both depart from Christchurch, providing amazing experiences for visitors.

# Take the road less travelled

The Ōtākaro Avon river runs through the heart of our city. And it's the perfect way to take in the sights. Whether you travel by punt or waka (Māori canoe), you'll discover the city's heritage and state-of-the-art architecture.

The Ōtākaro Avon River is the place where history meets progress and where we come together to enjoy the gifts of nature and take the time to connect with the things that matter most.



# New Zealand's newest oldest city



# Vibrant & contemporary



**Character Laneways**



**Anchored by the Avon River**



**Spectacular Dining & Entertainment**

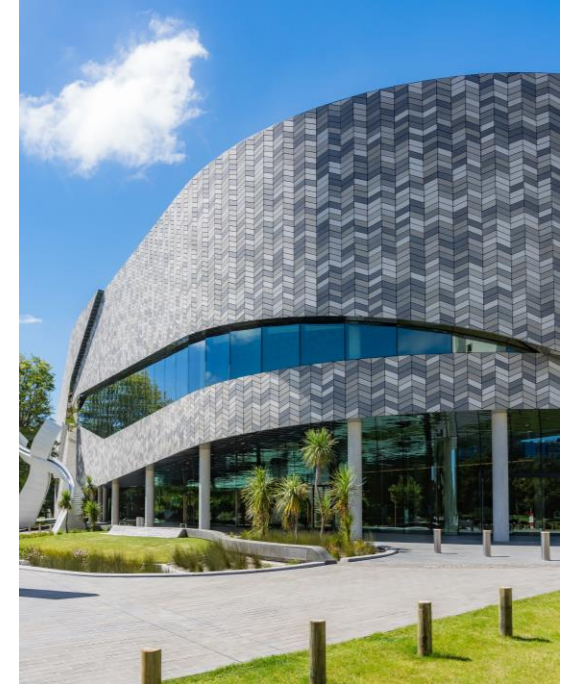

**Te Pae / architectural, design & green space precincts**

# Our inner-city laneways are a canvas

Ōtautahi Christchurch is a global capital of street art. We commission and nurture some of Aotearoa New Zealand's most celebrated and exciting artists – as well as some big international names. We display their work with pride.

We give them space to play, experiment and express themselves. You'll see their art everywhere you go. Colours and concepts abound, ready to inspire you at every turn. A true expression of our culture, our diverse communities and our city as a whole.





# Wine and Dine



## Riverside Kitchen & Market

Get hands on and brush up on your cooking skills at [Riverside Kitchen](#) or just sit back and enjoy a culinary experience.



## Cellar Door

Set in the beautiful Arts Centre, [Cellar Door](#) offers wine tasting flights, craft beer, gin, whisky and more.



## Tussock Hill

Nestled on the rocky slopes of the Port Hills only 20 minutes from the city centre, [Tussock Hill](#) is an exceptional lunch destination

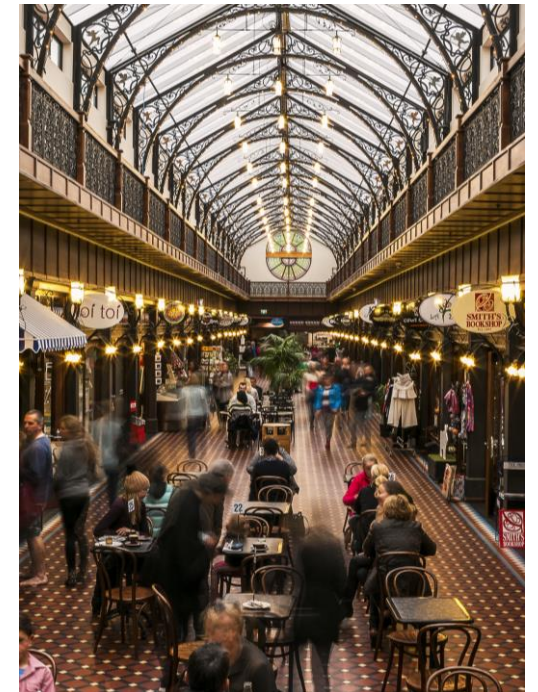

## The Tannery

[The Tannery](#) boutique shopping centre has a range of exciting and unique shops. It's also home to Cassels Brewery Bar and Restaurant.



Stay

# Stay



## The Observatory Hotel

Brings contemporary style to the heart of a precinct rich with history.



## The Mayfair Hotel

The Mayfair blends thoughtful design and attentive service to create a relaxed, modern environment in the central city.



## Eliza's Manor

Luxury boutique B&B and fine dining restaurant



## Novotel Christchurch Airport

Adjacent to the Airport with views over the runway and towards the Southern Alps

# Experience



# Activities & experiences



Waka on Avon

Cultural tours on the Otakaro  
Avon River



Christchurch Gondola

Stunning view over the Port Hill  
and Southern Alps



Amiki Tours

Walking & foodie tours in the  
central city

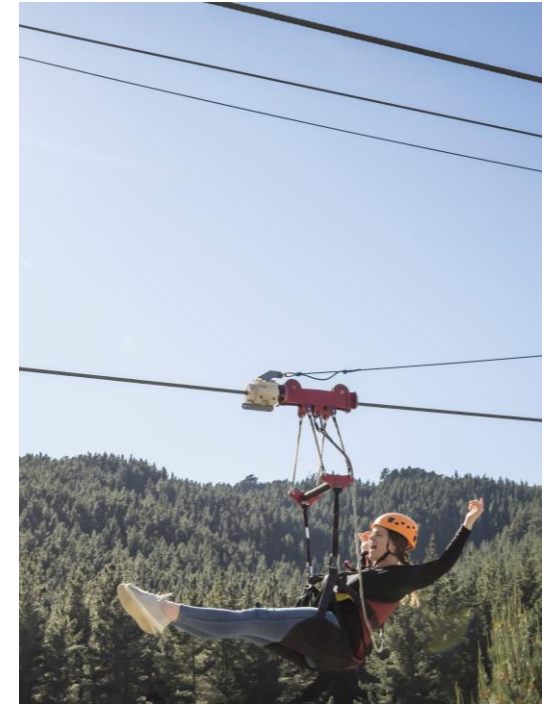

Christchurch Adventure  
Park

NZ's highest and longest zipline

# The most luxurious place to soak in the view

Puna Taimoana is Aotearoa New Zealand's only hot pools experience by the sea. The perfect spot to enjoy stunning views from one of five luxurious pools.

Nothing and rejuvenating, this is the place to sit back, relax and watch the waves lap the golden sand of New Brighton beach.

We recommend coming at sunset and grabbing a cocktail to make the moment even more...perfect.



# Our neighbours



Akaroa



Mid Canterbury



Hurunui & Kaikōura



Mackenzie



# The most stunning way to get back to nature

“Jaw-dropping”, “breath-taking” and “awe-inspiring”. Just some of the words visitors use to describe the incredible beauty of our natural surroundings.

From hills to beaches, forests to bays, the Canterbury region has been blessed with some of the most beautiful playgrounds and wildlife in the world. So, make some time to reconnect with the wonders of nature and let our scenery blow you away.





# Travel Trade Resources



IMAGE GALLERY – Update websites and client itineraries

PRODUCT TRAINING – Request a webinar

TRADE HUB -  
[www.christchurchnz.com/tradehub](http://www.christchurchnz.com/tradehub)

